

**Canon**

**EF100mm 1:2.0  
REF.NO.C21-7301**

**PARTS  
CATALOG**

# CANON LENS EF 100 mm 1:2.0

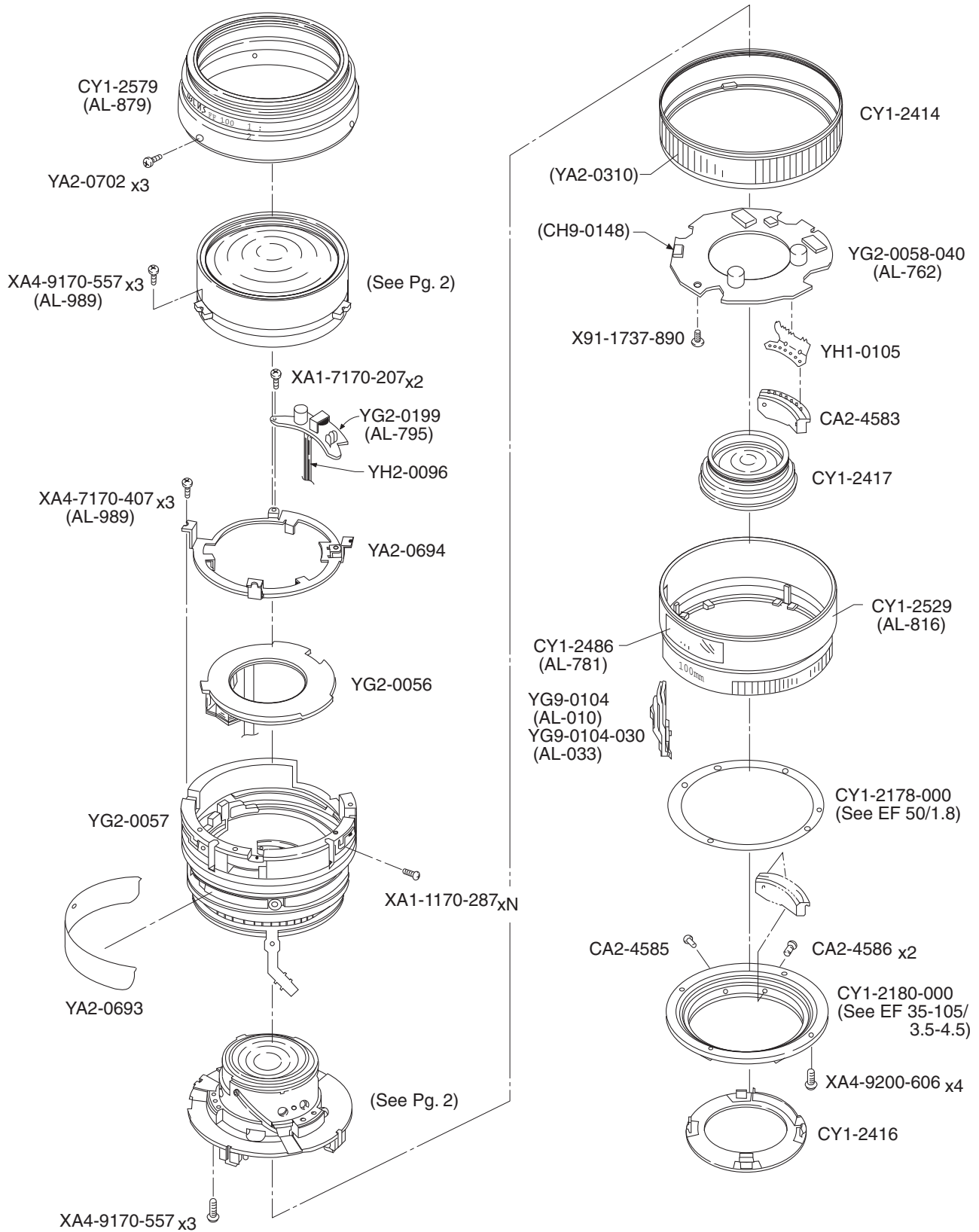

# CANON LENS EF 100 mm 1:2.0

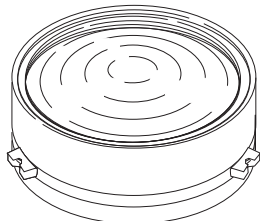

N.S

(A)  
(B) } YP2-0264

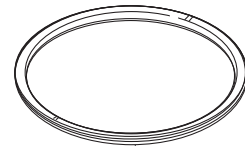
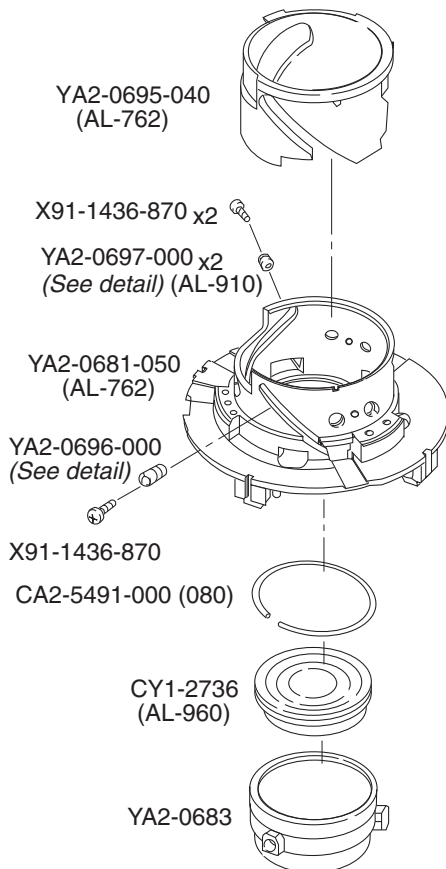

YA2-0010

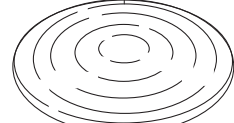

YN2-0261

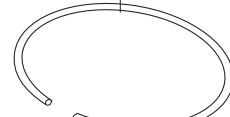

YA2-0699

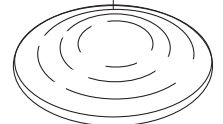

CY1-2735 (AL-960)

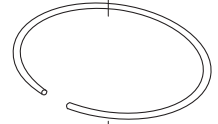

YA2-0700

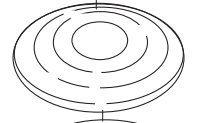

(A)

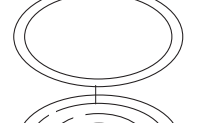

YA2-0701

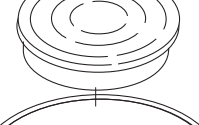

(B)

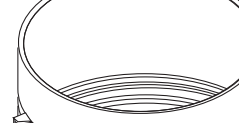

YA2-0682

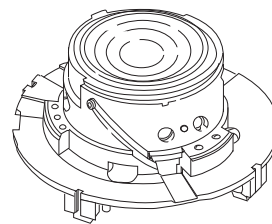

N.S

YA2-0696-000 detail

YA2-0697-000 detail (AL-910)

	A	SIZE
	ø3.99 mm	(399)
	ø4.00 mm	(400)
	ø4.01 mm	(401)

	A	SIZE
	ø3.98 mm	(398)
	ø3.99 mm	(399)
	ø4.00 mm	(400)
	ø4.01 mm	(401)

# PARTS LIST

REF.No.C21-7301

NEW	PART NO.	CLASS	QTY	DESCRIPTION	PAGE
	CA2-4583-000	D	1	CONTACT ASS'Y	1
	CA2-4585-000	E	1	SCREW, MOUNT STOPPER	1
	CA2-4586-000	E	2	SCREW	1
	CA2-5491-000(080)	E	1	RING, SNAP	2
	CH9-0148-000	E	1	SWITCH, SLIDE	1
	CY1-2178-000(XXX)	E	1	WASHER, MOUNT	1
	CY1-2180-000(XXX)	C	1	MOUNT, LENS	1
	CY1-2414-000	E	1	FOCUSING RING ASS'Y	1
	CY1-2416-000	D	1	COVER, REAR	1
	CY1-2417-000	E	1	LENS(G7/8)ASS'Y	1
	CY1-2486-000	D	1	SCALE, DEPTH OF FIELD	1
	CY1-2529-000	D	1	SLEEVE, INDICATOR	1
	CY1-2579-000	D	1	FRONT SLEEVE ASS'Y	1
	CY1-2735-000	E	1	LENS, G2	2
	CY1-2736-000	E	1	LENS, G5/6	2
	X91-1436-870		3	SCREW, CROSS-RECESS, PH	2
	X91-1737-890		1	SCREW, CROSS-RECESS, PH	1
	XA1-1170-287		N	SCREW, CROSS-RECESS, PH	1
	XA1-7170-207		2	SCREW, CROSS-RECESS, PH	1
	XA4-7170-407		3	SCREW, CROSS-RECESS, PH	1
	XA4-9170-557		6	SCREW, CROSS-RECESS, PH	1
	XA4-9200-606		4	SCREW, CROSS-RECESS, PH	1
	YA2-0010-000	D	1	COLLAR, ASSEMBLY	2
	YA2-0310-000	D	1	RING, RUBBER	1
	YA2-0681-050	D	1	BARREL, FIXED	2
	YA2-0682-000	D	1	BARREL, LENS	2
	YA2-0683-000	E	1	BARREL, LENS	2
	YA2-0693-000	E	1	SCALE, FOCUSING	1
	YA2-0694-000	E	1	RING, RETAINING	1
	YA2-0695-040	D	1	RING, LIGHT SHIELD	2
	YA2-0696-000(XXX)	E	1	COLLAR, FOCUSING	2
	YA2-0697-000(XXX)	E	2	COLLAR, FOCUSING	2
	YA2-0699-000	E	1	RING, SNAP	2
	YA2-0700-000	E	1	RING, SNAP	2
	YA2-0701-000	E	1	SPACER	2
	YA2-0702-000		3	SCREW, CROSS-RECESS, PH	1
	YG2-0056-000	D	1	POWER DIAPHRAGM UNIT	1
	YG2-0057-000	D	1	FOCUSING UNIT	1
	YG2-0058-040	D	1	MAIN CBA ASS'Y	1
	YG2-0199-000	D	1	CONVERTER, DC/DC	1
	YG9-0104-000	D	1	A/M SWITCH ASS'Y	1
	YG9-0104-030	D	1	A/M SWITCH ASS'Y	1
	YH1-0105-000	E	1	FLEX, CONNECTING	1
	YH2-0096-000	E	1	CABLE, FLAT	1
	YN2-0261-000	D	1	LENS, G1	2
	YP2-0264-000	E	1	LENS, G3/4	2

# CANON LENS EF 100mm 1:2.0

